



*New Launch*

# LDLR250 DATA CENTRE LIFTER

*Introducing a 250kg Heavy Duty  
Data Centre Lifter*



# ENGINEERD

for **PERFORMANCE**



**Lift Rite** has announced the launch of a new **250kg capacity data centre lifter** designed to make the installation and maintenance of IT equipment safer, faster, and more efficient.

The new lifting solution has been engineered specifically for **data centre environments**, where technicians frequently need to install heavy servers, storage units, and networking equipment into racks at height. With a maximum lifting capacity of 250kg, the lifter enables a single operator to safely move and position equipment that would otherwise require multiple personnel or pose manual-handling risks.

Data centre servers and associated hardware are often heavy and awkward to install, particularly when working in narrow aisles or elevated rack positions. Purpose-built server lifters are designed to **raise, transport, and precisely align IT equipment during rack installation**, reducing both injury risk and potential damage to high-value hardware.



The new **Lift Rite** unit has been developed with a number of features aimed at **supporting modern data centre operations**, including:

## STANDARD FEATURES

- **250kg safe working load (SWL)** suitable for large servers and storage arrays
- **Ergonomic Design** With 260kg test load only 4.5kg (approx. 44N), force push to start
- **Precision lift mechanism** Stepless speed control for controlled installation into racks
- **Compact footprint** for manoeuvring in narrow data centre aisles
- **Stable platform design** to ensure safe alignment during installation
- **Adjustable touch points** allowing a single technician to complete lifting tasks
- **In line masts for clear vision** slim build mast to optimise view for the operator
- **Auto Reverse top sensor Collision sensor** to reverse upward motion
- **Electric side shift** Up to 25mm/s, 150mm side movement in each direction
- **Adjustable platform tilt** Manual fine tuning of platform angle
- **Battery Exchange** - Can be charge remotely, option for two batteries (24hr opera.)
- **Keyless Stop / Start lockout with pin code** (can be toggled on / off)
- **Directional lock for rear wheels**, also foot operated brake bar
- **Storage Shelf** incorporated in to design for operator use
- **Impact protected battery charger**, 24VDC/1.5Ah,100-240VAC, UL/CE. Plug for EU/UK/US/AU

## OPTIONAL FEATURES

- **Electric Tilt Electric**  
Fine tuning of platform, angle to adapt insertion with heavy load
- **USB C Power Out**  
60W power supply for laptop or phone etc.

These features help address the increasing weight and density of modern IT infrastructure, while supporting safer working practices for engineers responsible for rack and stack operations.

## SUPPORTING SAFE MANUAL HANDLING

Manual handling remains a major concern in technical environments such as data centres. Equipment designed for controlled lifting can significantly reduce the risk of injury and equipment damage during installation or maintenance tasks. Server lifters allow heavy IT hardware to be positioned accurately at rack height while remaining fully supported by the platform.

The new 250kg lifter is intended to help organisations comply with workplace safety regulations while improving operational efficiency within mission-critical facilities.

The launch of the new data centre lifter reflects the company's continued focus on developing specialised solutions for industries where precision handling and safety are critical.

### Specifications

<b>Minimum platform height</b>	110 mm
<b>Maximum platform height</b>	2300 mm
<b>Dimensions of platform</b>	620x490 mm
<b>Platform-Movement</b> (off center)	+/- 150 mm
<b>Front wheel specification</b> (PU ESD wheel)	Double wheel 2x: w40 mm x d100 mm
<b>Rear wheel specification</b> (PU ESD wheel)	Width 71 mm, d125 mm
<b>Overall Dimensions</b> (LxBxH)	1131 x 636 x 1876 mm
<b>Maximum Load</b>	Max 250 kg
<b>Lifting speed empty</b>	78 mm/s
<b>Net weight</b>	180 kg
<b>Safety</b>	CE EU 2023/1230 UL 2344 (1323) IEC 60204-1



# LDLR250 DATA CENTRE LIFTER

## Components

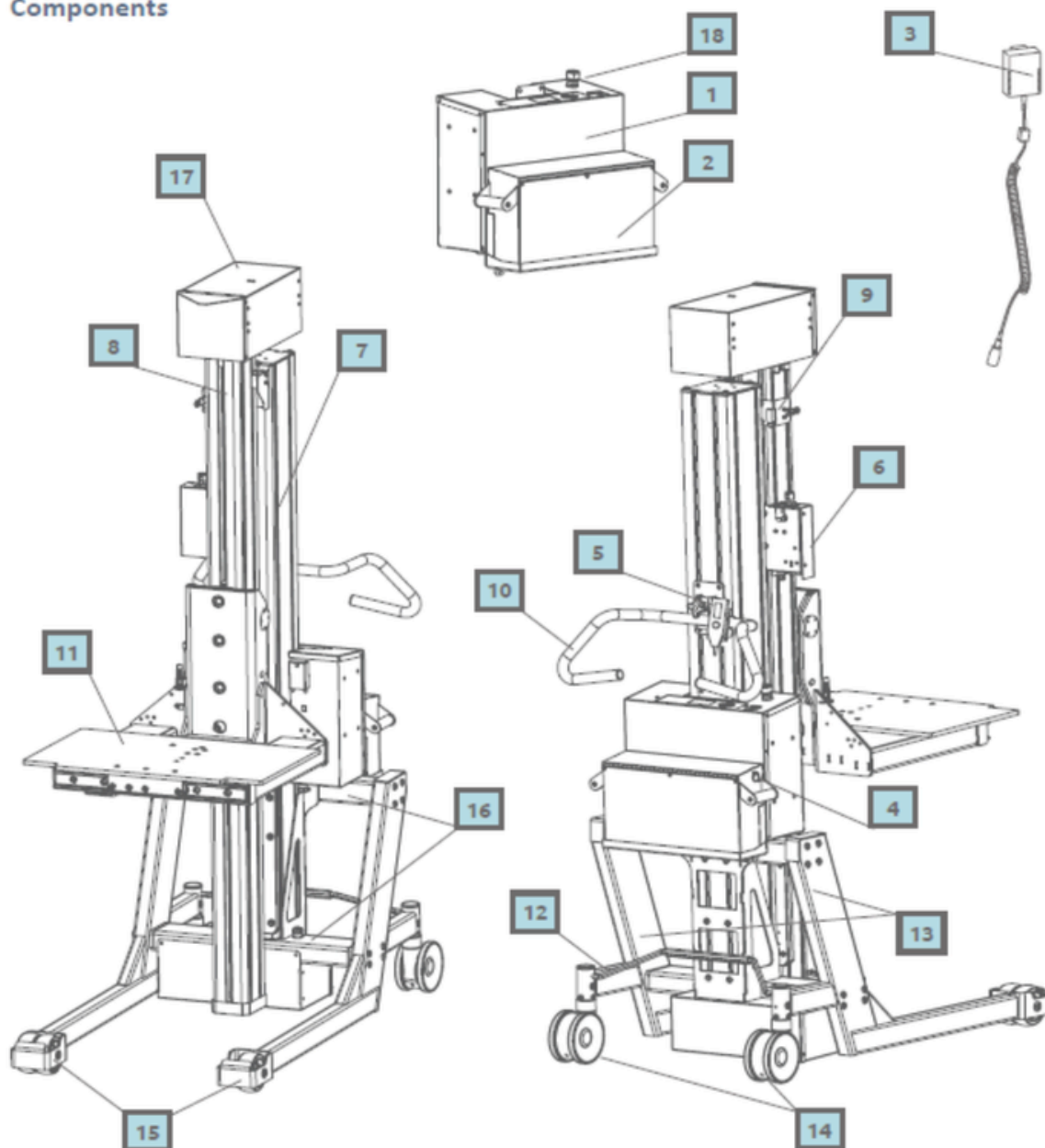

1. Control unit
2. Battery unit
3. Battery charger
4. Charger plug
5. Hand control
6. Control box
7. Second column
8. First column
9. Limit switch

10. Handlebar
11. Sliding motorized platform
12. Brake rod
13. Wheel frame
14. Rear castor
15. Front castor
16. Cross-member
17. Top collision sensor
18. Emergency stop



## LIFT RITE LTD.

F1 Maynooth Business Campus, Maynooth, Co. Kildare  
W23 V8Y4

 +353 1 601 6106

 [info@liftrighte.ie](mailto:info@liftrighte.ie)

 [www.lift.ie](http://www.lift.ie)