

## **Fully powered Panther pallet truck - easy and smooth movement**

High flexibility and efficiency - Panther Mini and Panther Maxi move many different pallets in very confined areas both easily and quietly.

No damage to surroundings, pallets and goods  
- Panther Mini and Panther Maxi have an elegant design with rounded corners.

The design puts focus on the safety and ergonomic working conditions of the user. As an example, the ergonomically correct handle ensures the user a relaxed hold.

High quality is ensured through an extended test programme and in cooperation with experts in Health and Safety.



## Technical Specifications

The trucks are available in two models

- Mini - capacity of 1400 kg - recommended for light pallet transport
- Maxi - capacity of 1800 kg - recommended for heavy pallet transport

Optimum space utilisation

- length behind the forks of 450 mm
- tight turning angle of 210°
- narrower than the width of a EUR pallet - it can operate in aisles as narrow as a pallet width

Further advantages

- AC-technology
- Easy service and setting of e.g. driving speed, acceleration and deceleration
- Long operation time per charge
- Motor brake - optimum safety
- No brushes in the wheel motor - reduced maintenance



Panther Mini (capacity 1400 kg) is recommended for easy pallet transport, e.g. in super markets and in stock areas.



Panther Maxi (capacity 1800 kg) is recommended for heavy pallet transport, e.g. in the transport industry.



Possible to operate with handle upright. Central location of all control buttons.



Strong construction ensures a long operating life and low maintenance costs.



Easy access to all components makes service of the truck straightforward.

Product (measured in mm)	Panther Mini	Panther Maxi
Capacity	1400 kg	1800 kg
Lifting height	h <sub>3</sub>	195, 200
Fork length	l	810, 915, 970, 1066, 1140, 1220, 1520*
Overall height	h <sub>1</sub>	647
Overall width b <sub>5</sub> =520/b <sub>5</sub> =680	b <sub>1</sub>	600/680
Fork span	b <sub>5</sub>	520, 680
Fork width	e	158
Length without forks	l <sub>2</sub>	450
Overall length	l <sub>1</sub>	450 + l
Overall height	h <sub>14</sub>	1296
Lowered height	h <sub>13</sub>	80, 85
Load centre	c	l/2
Wheel base (l=1140)	y	1256
Gangway	A <sub>st</sub>	1890** (pallet: 1200 x 800)
Turning angle of the wheels		210°
Turning radius Wa (l=1140)		1410
Driving motor - speed control electronically variable	24 V 0,7 kW	24 V 1,2 kW
Driving speed with/without load	4/5 km/h	5/6 km/h
Pump motor	24V 1,2 kW	24V 1,2 kW
Lifting speed with/without load	35/50 mm/s	35/50 mm/s
Lowering speed with/without load	115/40 mm/s	115/40 mm/s
Gradient performance	10%	10%
Battery	60 Ah (2x12 V)	120 Ah (1x24 V) or 160 Ah (1x24 V)
Weight in kg with 1140 mm forks (without battery)	203	205

\* Only Panther Maxi.

\*\* Tests show that 1610 mm are enough.

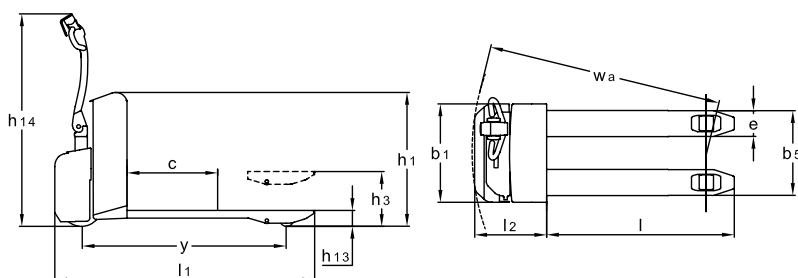

We also offer tailor-made solutions.

Please ask for further information or visit our website [www.logitrans.com](http://www.logitrans.com)



Unit F1, Maynooth Business Campus  
Maynooth, Co Kildare, Ireland  
Tel: +(353) 1 6016106 • Fax: +(353) 1 6016109  
e-mail: [info@liftrite.ie](mailto:info@liftrite.ie) • web: [www.liftrite.ie](http://www.liftrite.ie)