

Fully powered Logiflex Mini AC – light, flexible and safe!

Logiflex Mini AC is a light and manoeuvrable fully powered stacker – your best choice for the light handling in minor storage and shopping areas.

The design puts focus on the safety and ergonomic working conditions of the user. Logiflex Mini AC can be adjusted to the individual user, and the ergonomic correct handle ensures the user a relaxed hold. The low overall height gives optimum view conditions.

No damage to surroundings, pallets and goods – Logiflex has an elegant design with rounded corners.

High quality is ensured through an extended test programme and in cooperation with experts in Health and Safety.



Technical Specifications

Logiflex Mini AC gives the user

- easy setting of e.g. driving speed and acceleration
- compact construction
 - perfect in confined areas
- easy service
 - easy access to batteries
- low overall height – optimum view
- motor brake
- long operation time per charge



Possible to operate with the handle upright. Central location of all control buttons.



Hour counter, battery indicator and error finding in the same instrument.



Available with optional extras, e.g. crane arm, drum turner, boom, remote control and level control.

Product (measured in mm)	SELF Mini AC		SELF Mini AC		SELS Mini AC		SELS Mini AC	
Capacity in kg	1000		1000		1000		1000	
Lifting height with wrap-over forks	h_3	920	1650		890		1620	
Fork length	l	600/800/1150/1520*						
Overall height	h_1	1320	1350		1320		1350	
Overall width	b_1	635, 710			166+ b_4			
Fork span	b_5	560, 680			Wrap-over: 350/800, chisel and bar: 230/680			
Length without forks	l_2	545			590			
Overall length with 1150 forks	l_1	1755	1765		1855		1865	
Overall height	h_4	1320	2025		1320		1995	
Lowered height, forks	h_{13}	90			Wrap-over: 65, chisel: 45, bar: 65			
Load centre	c	l/2						
Width between legs	b_4				850-942, 942-1124, 1124-1306, 1240-1422**			
Fork width	e	163						
Run-in length	l_x	1100 with 1150 mm forks			1080 with 1150 mm forks			
Gangway (w/pallet: 1200 x 800)	A_{st}	2200 - tests show that 1700 mm are enough - depends on b_4						
Free lift	h_2			330			330	
Turning angle of the wheels	210°							
Motor	0,7 kW 24 V speed control electronically variable							
Driving speed with/without load	Below 500 mm lift: 4/5 km/h, over 500 mm lift: 3/4 km/h							
Pump motor	1,2 kW 24 V							
Lifting speed with/without load	0,07/0,12 m/s							
Lowering speed with/without load	0,12/0,07 m/s							
Weight in kg (without battery)	308		363		348		403	

* Reduced capacity 750 kg.

** Width between straddle legs of more than 1306 mm: Max. capacity 800 kg. Fork length of 1520 mm is not recommended.



For intensive use, we recommend SELF or SELFS.

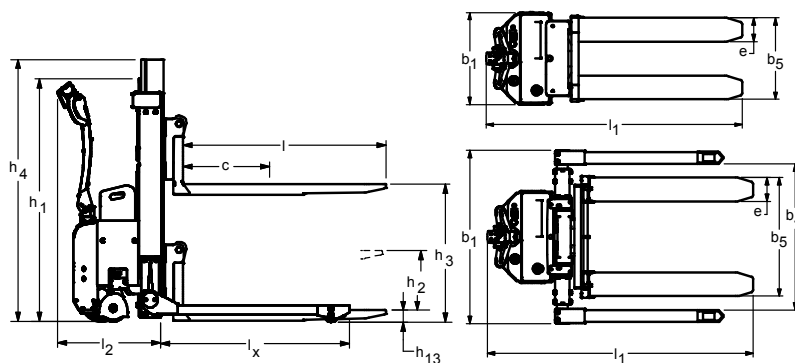

We also offer tailor-made solutions.

Please ask for further information or visit our website www.logitrans.com



Unit F1, Maynooth Business Campus
 Maynooth, Co Kildare, Ireland
 Tel: +(353) 1 6016106 • Fax: +(353) 1 6016109
 e-mail: info@liftrite.ie • web: www.liftrite.ie